

3D view of feature planting



Border Area



Planting Plan

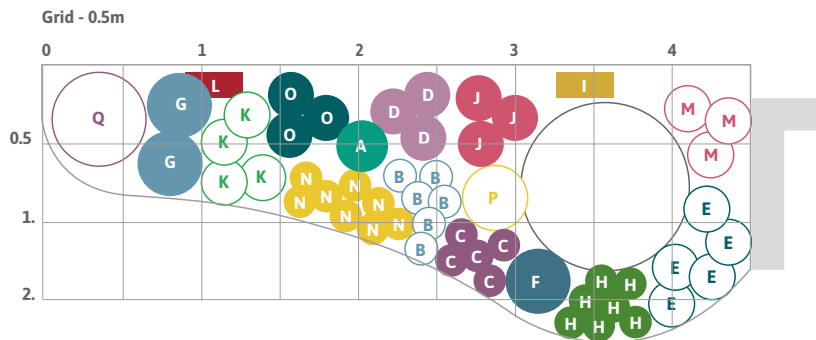

This border can be recreated in most gardens and works well in sunny or semi-shaded spots.

Plants have greater visual impact when grouped in multiples and the further from the house or main viewing area, the greater the multiple should be,' advises Jane McCorkell.

Bulbs to plant in this area include Muscari, commonly known as blue grape hyacinths for their bell shape and grape juice fragrance; Narcissus 'Tête-à-tête' (miniature daffodils); and Fritillaria varieties from the lily family.

Amelanchier lamarkii multi-stem – also called June berry – sits centre stage, with foliage changing hue throughout the seasons from a copper colour in spring, to green in summer and scarlet in autumn. Its white flowers bloom in spring and are followed by purple black berries in summer, which are a great food source for birds and safe for humans too.

You can make your own multi-stem tree (a tree with two or more stems) by planting three single-stem small trees in the one hole. 'Angle and train them outwards over the years to create a focal point,' says Jane. Installing an uplighter at the base of the tree will have a striking effect in winter.

You will find the full list of plants in the **planting plan**.

Border Plant List

A	Amelanchier lamarkii [Multistem]
B	Aquilegia vulgaris var. stellata 'White Barlow'
C	Bergenia 'Baby Doll'
D	Brunnera macrophylla 'Jack Frost'
E	Brunnera macrophylla 'Looking Glass'
F	Cornus canadensis
G	Dicentra spectabilis
H	Epimedium 'Lilafee'
I	Hedera helix 'Hibernica'
J	Helleborus foetidus
K	Helleborus orientalis
L	Hydrangea anomala subsp. Petiolaris
M	Osmunda regalis
N	Primula vialii
O	Pulmonaria 'Blue Ensign'
P	Sarcococca confusa
Q	Spirea 'Arguta'